



# BUILDING A BETTER I-4

### Stay Informed:

- » Project Hotline: 844-ULT-INFO (858-4636)
- » Sign up for email and text alerts at [fdot.tips/I4Alerts](https://fdot.tips/I4Alerts)
- » Follow @i4Ultimate on Twitter
- » Subscribe to our monthly newsletter at [fdot.tips/I4News](https://fdot.tips/I4News)

## WESTBOUND I-4 REDUCED TO SINGLE LANE THROUGH DOWNTOWN MAY 14-18

The Florida Department of Transportation (FDOT) is reducing westbound Interstate 4 (I-4) lanes between Princeton Street and Gore Street from as early as 9 p.m. Thursday, May 14, through 6 a.m. Monday, May 18. Motorists may consider exiting at Lee Road and traveling south on Orange Blossom Trail or John Young Parkway through downtown Orlando to bypass lane closures (see details below). Throughout the weekend between 9 p.m. and 6 a.m., traffic may be intermittently detoured off I-4 at Ivanhoe Boulevard.

Multiple closures will be implemented at various times between May 11-18.

- See page 2 for the nighttime detour of westbound I-4 downtown.
- See page 3 for the 7-day closure of westbound exit to Anderson Street.
- See page 4 for nighttime detours of westbound on ramp from South Street.
- See page 5 for nighttime closures of eastbound and westbound I-4 ramps to S.R. 408.
- See page 6 for the closure of the eastbound S.R. 408 ramp to eastbound and westbound I-4.
- See page 7 for nighttime closures of westbound S.R. 408 and the westbound S.R. 408.

Three lanes open from Maitland Boulevard to Par Street

One lane open, two lanes closed from Princeton Street to Gore Street

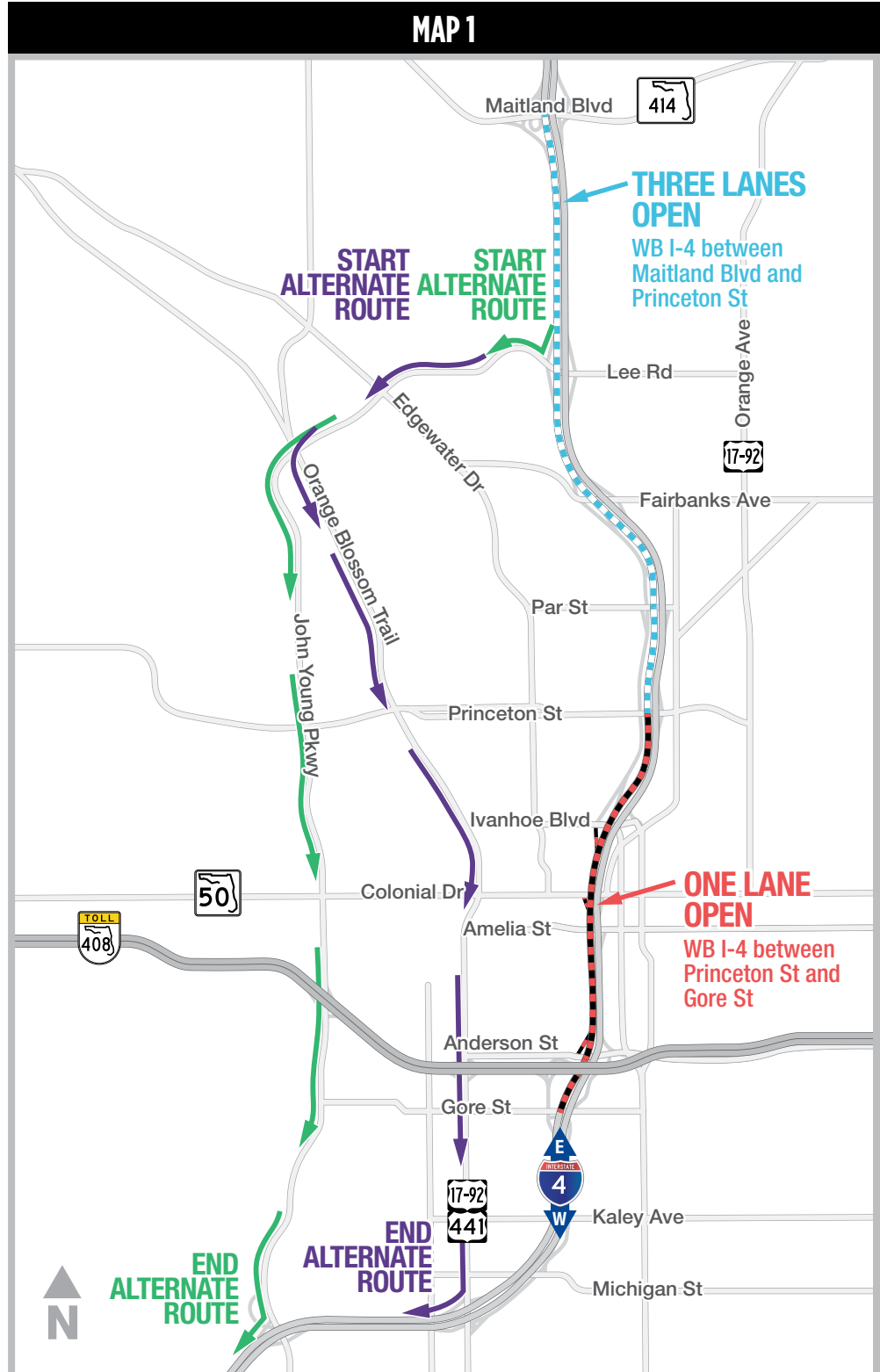



# BUILDING A BETTER I-4

## Stay Informed:

- » Project Hotline: 844-ULT-INFO (858-4636)
- » Sign up for email and text alerts at [fdot.tips/I4Alerts](https://fdot.tips/I4Alerts)
- » Follow @i4Ultimate on Twitter
- » Subscribe to our monthly newsletter at [fdot.tips/I4News](https://fdot.tips/I4News)

## WESTBOUND I-4 INTERMITTENTLY CLOSED OVERNIGHT AT IVANHOE BOULEVARD

The Florida Department of Transportation (FDOT) may be detouring all westbound Interstate 4 (I-4) traffic off the interstate at Ivanhoe Boulevard from 9 p.m to 6 a.m. over the weekend. Motorists should plan extra time to travel through downtown Orlando during overnight hours.

Multiple closures will be implemented at various times between May 11-18.

- See page 1 for westbound I-4 lane closures through downtown Orlando.
- See page 3 for the 7-day closure of westbound exit to Anderson Street.
- See page 4 for nighttime detours of westbound on ramp from South Street.
- See page 5 for nighttime closures of eastbound and westbound I-4 ramps to S.R. 408.
- See page 6 for the closure of the eastbound S.R. 408 ramp to eastbound and westbound I-4.
- See page 7 for nighttime closures of westbound S.R. 408 and the westbound S.R. 408 .

### Traveling on westbound I-4:

- Exit to Ivanhoe Boulevard (Exit 84)
- Turn left onto eastbound Ivanhoe Boulevard
- Turn right onto Legion Place/ Orange Avenue
- Turn right onto Colonial Drive (S.R. 50)
- Turn left onto Orange Blossom Trail
- Follow signs to westbound I-4

MAP 2

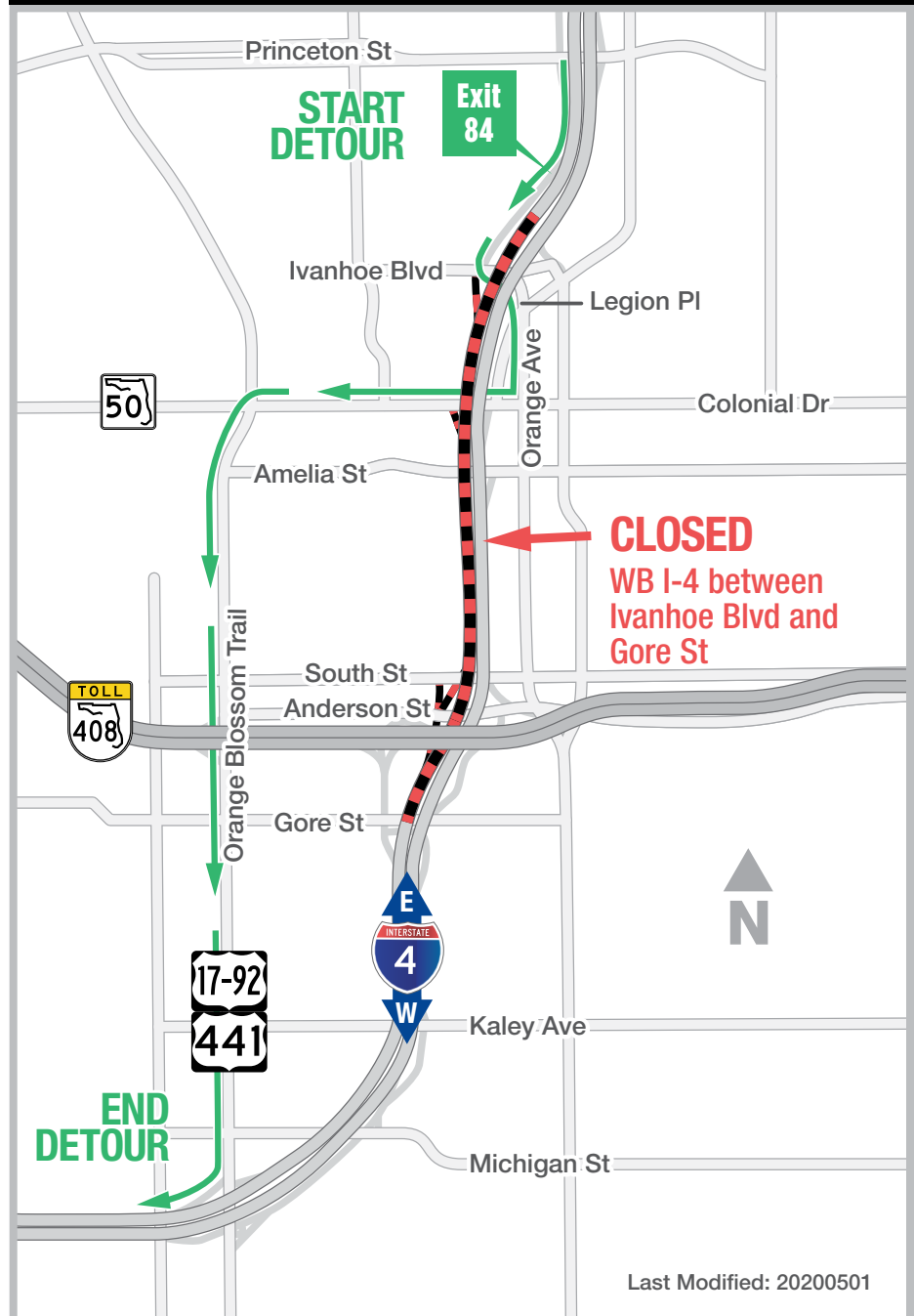

Last Modified: 20200501



Sign up for I-4 Construction Updates and Alerts at [I4Ultimate.com](https://I4Ultimate.com)

Learn about design and construction on the next 40 miles of I-4 at [I4Beyond.com](https://I4Beyond.com)



# BUILDING A BETTER I-4

## Stay Informed:

- » Project Hotline: 844-ULT-INFO (858-4636)
- » Sign up for email and text alerts at [fdot.tips/I4Alerts](https://fdot.tips/I4Alerts)
- » Follow @i4Ultimate on Twitter
- » Subscribe to our monthly newsletter at [fdot.tips/I4News](https://fdot.tips/I4News)

## WESTBOUND I-4 EXIT TO ANDERSON STREET CLOSED MAY 11-18

The Florida Department of Transportation (FDOT) is temporarily closing the westbound Interstate 4 (I-4) exit ramp to Anderson Street (Exit 82B) as soon as 9 p.m. Monday, May 11, through 6 a.m. Monday, May 18.

Multiple closures will be implemented at various times between May 11-18.

- See page 1 for westbound I-4 lane closures through downtown Orlando.
- See page 2 for the nighttime detour of westbound I-4 downtown.
- See page 4 for nighttime detours of westbound on ramp from South Street.
- See page 5 for nighttime closures of eastbound and westbound I-4 ramps to S.R. 408.
- See page 6 for the closure of the eastbound S.R. 408 ramp to eastbound and westbound I-4.
- See page 7 for nighttime closures of westbound S.R. 408 and the westbound S.R. 408.

### Traveling on westbound I-4 to Anderson Street:

- Use Exit 84 to Ivanhoe Boulevard
- Turn left on Ivanhoe Boulevard
- Turn right onto Legion Pl/Orange Ave
- Turn right onto Colonial Drive (S.R. 50)
- Turn left onto Orange Blossom Trail

### Traveling on westbound I-4 to Michigan Street:

- Use Exit 79 to John Young Parkway
- Turn left on LB McLeod Road
- Turn left on Rio Grande Avenue
- Turn right on 29th Street
- Turn left on Orange Blossom Trail

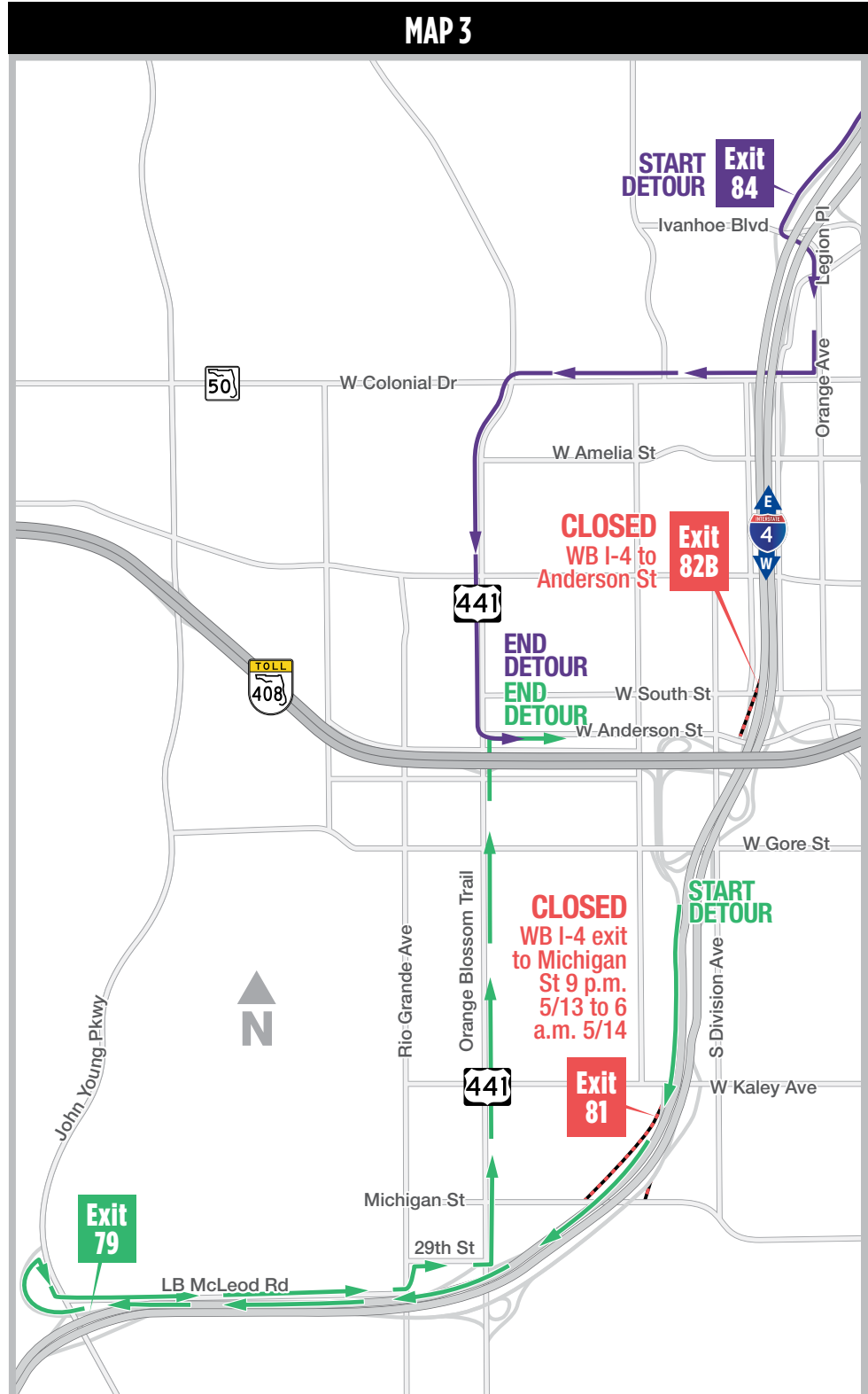



# BUILDING A BETTER I-4

## Stay Informed:

- » Project Hotline: 844-ULT-INFO (858-4636)
- » Sign up for email and text alerts at [fdot.tips/I4Alerts](mailto:fdot.tips/I4Alerts)
- » Follow @i4Ultimate on Twitter
- » Subscribe to our monthly newsletter at [fdot.tips/I4News](mailto:fdot.tips/I4News)

## WESTBOUND I-4 ENTRANCE RAMP FROM SOUTH STREET CLOSING

The Florida Department of Transportation (FDOT) is temporarily closing the westbound Interstate 4 (I-4) entrance ramp from South Street. The South Street ramp will be closed from 9 p.m. Friday, May 15, to 6 a.m. Monday, May 18.

Multiple closures will be implemented at various times between May 11-18.

- See page 1 for westbound I-4 lane closures through downtown Orlando.
- See page 2 for the nighttime detour of westbound I-4 downtown.
- See page 3 for the 7-day closure of westbound exit to Anderson Street.
- See page 5 for nighttime closures of eastbound and westbound I-4 ramps to S.R. 408.
- See page 6 for the closure of the eastbound S.R. 408 ramp to eastbound and westbound I-4.
- See page 7 for nighttime closures of westbound S.R. 408 and the westbound S.R. 408.

### Traveling on South Street to westbound I-4:

- Head south on Division Avenue
- Turn right on Kaley Street
- Follow signs to westbound I-4

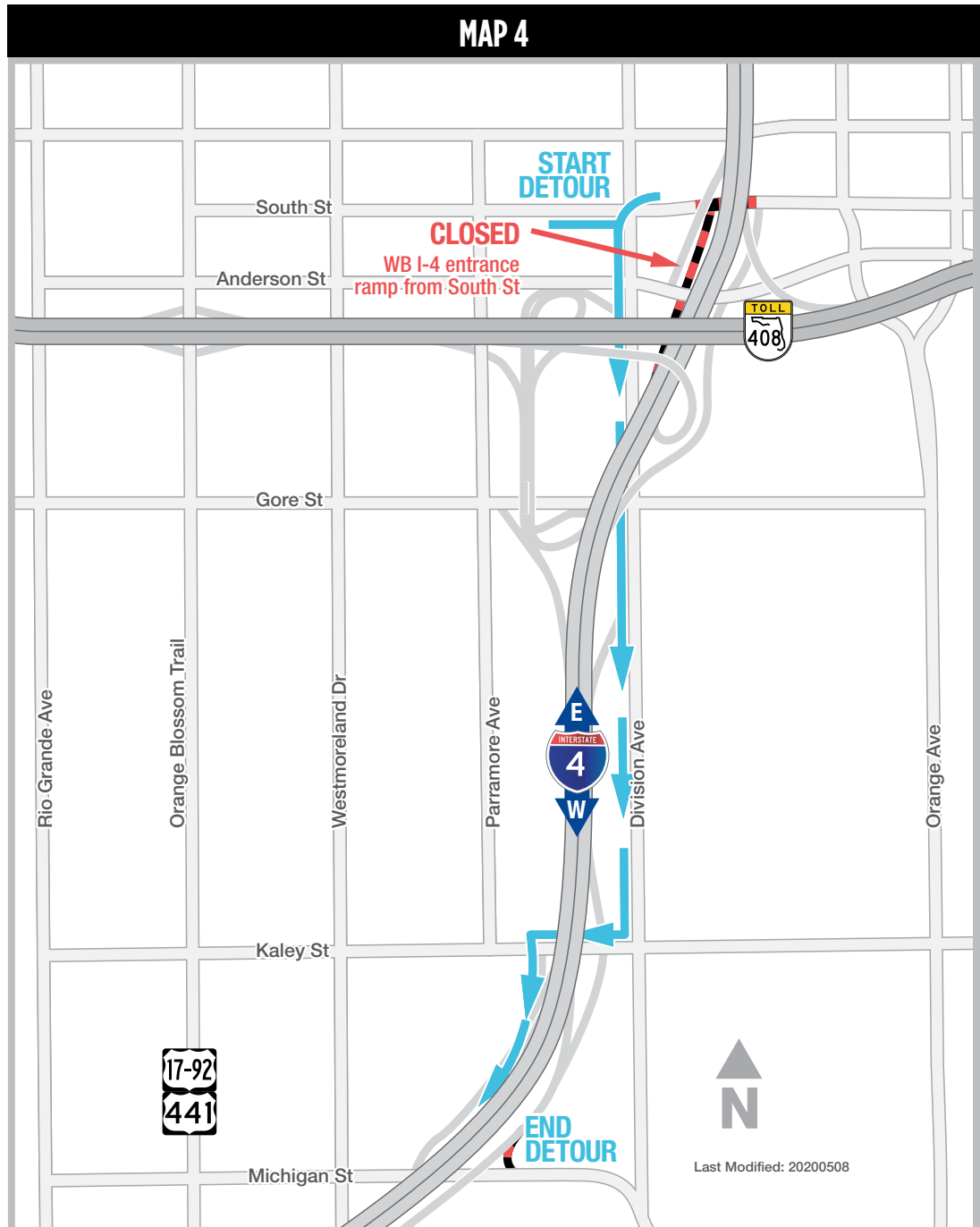

Sign up for I-4 Construction Updates and Alerts at [I4Ultimate.com](http://I4Ultimate.com)

Learn about design and construction on the next 40 miles of I-4 at [I4Beyond.com](http://I4Beyond.com)



# BUILDING A BETTER I-4

## Stay Informed:

- » Project Hotline: 844-ULT-INFO (858-4636)
- » Sign up for email and text alerts at [fdot.tips/I4Alerts](https://fdot.tips/I4Alerts)
- » Follow @i4Ultimate on Twitter
- » Subscribe to our monthly newsletter at [fdot.tips/I4News](https://fdot.tips/I4News)

## EASTBOUND AND WESTBOUND I-4 RAMPS TO S.R. 408 CLOSING

The Florida Department of Transportation (FDOT) is closing the ramps from eastbound and westbound Interstate 4 (I-4) to State Road (S.R.) 408 from 9 p.m. Friday, May 15 through Monday, May 18. Drivers may also encounter S.R. 408 lane closures in each direction between Orange Avenue and Westmoreland Drive during overnight hours.

Multiple closures will be implemented at various times between May 11-18.

- See page 1 for westbound I-4 lane closures through downtown Orlando.
- See page 2 for the nighttime detour of westbound I-4 downtown.
- See page 3 for the 7-day closure of westbound exit to Anderson Street.
- See page 4 for nighttime detours of westbound on ramp from South Street.
- See page 6 for the closure of the eastbound S.R. 408 ramp to eastbound and westbound I-4.
- See page 7 for nighttime closures of westbound S.R. 408 and the westbound S.R. 408.

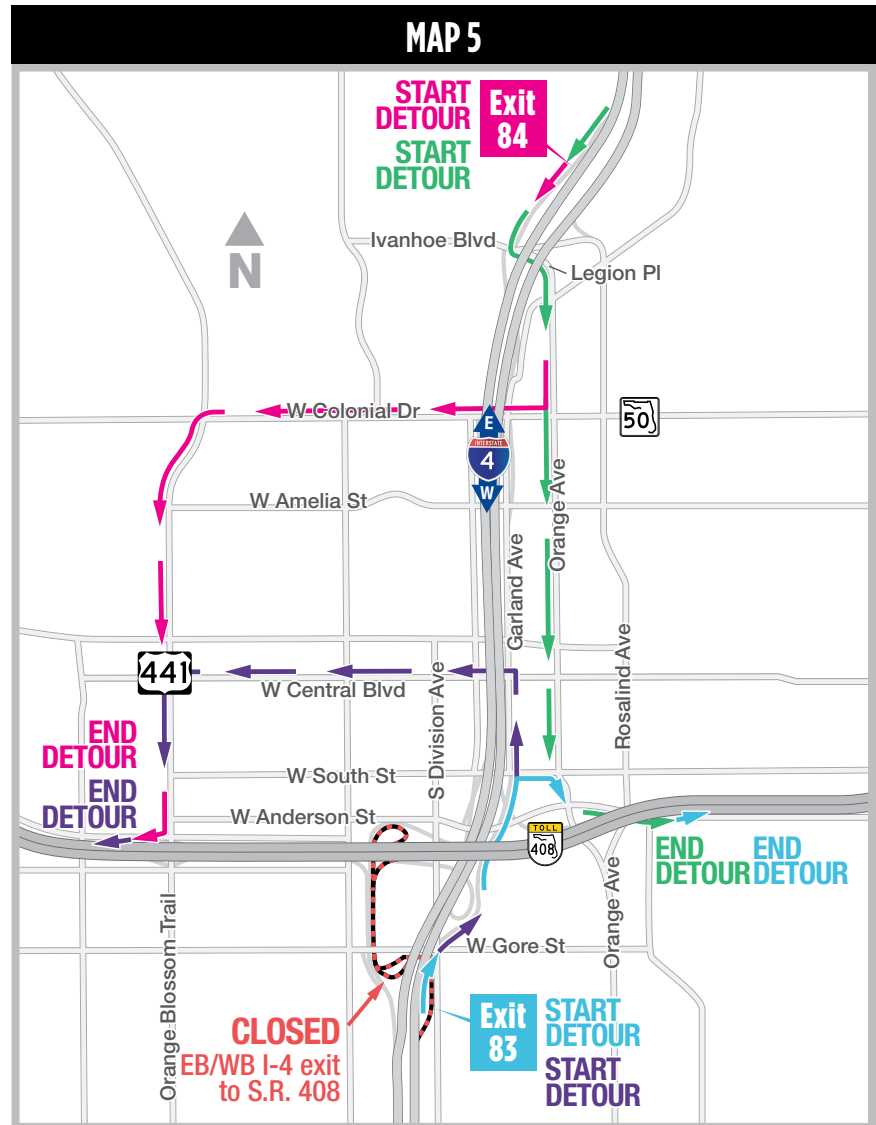

### Traveling on eastbound I-4 to eastbound S.R. 408:

- Use the Exit 83 to South Street
- Turn right onto South Street
- Turn right onto Orange Avenue
- Turn left onto Anderson Street
- Follow signs to eastbound S.R. 408

### Traveling on westbound I-4 to westbound S.R. 408:

- Exit to Ivanhoe Boulevard (Exit 84)
- Turn left onto eastbound Ivanhoe Boulevard
- Turn right onto Legion Place/ Orange Avenue
- Turn right onto Colonial Drive (S.R. 50)
- Turn left onto Orange Blossom Trail
- Follow signs to westbound S.R. 408

### Traveling on eastbound I-4 to westbound S.R. 408:

- Use the Exit 83 to South Street/Garland Avenue
- Turn left onto Central Boulevard
- Turn left onto Orange Blossom Trail
- Follow signs to westbound S.R. 408

### Traveling on westbound I-4 to eastbound S.R. 408:

- Use Exit 84 to Ivanhoe Boulevard
- Turn left on Ivanhoe Boulevard
- Turn right onto Legion Pl/Orange Ave
- Turn left onto Anderson Street
- Follow signs to eastbound S.R. 408



# BUILDING A BETTER I-4

## Stay Informed:

- » Project Hotline: 844-ULT-INFO (858-4636)
- » Sign up for email and text alerts at [fdot.tips/I4Alerts](https://fdot.tips/I4Alerts)
- » Follow @i4Ultimate on Twitter
- » Subscribe to our monthly newsletter at [fdot.tips/I4News](https://fdot.tips/I4News)

## EASTBOUND S.R. 408 RAMPS TO EASTBOUND AND WESTBOUND I-4 CLOSING

The Florida Department of Transportation (FDOT) is closing the eastbound State Road (S.R.) 408 to eastbound and westbound Interstate 4 (I-4) ramps at night. The eastbound S.R. 408 ramps to both eastbound and westbound I-4 will be closed from 9 p.m. Sunday, May 17 through Monday, May 18. Drivers may encounter two lanes of S.R. 408 closed in each direction between Orange Avenue and Westmoreland Drive during overnight hours.

Multiple closures will be implemented at various times between May 11-18.

- See page 1 for westbound I-4 lane closures through downtown Orlando.
- See page 2 for the nighttime detour of westbound I-4 downtown.
- See page 3 for the 7-day closure of westbound exit to Anderson Street.
- See page 4 for nighttime detours of westbound on ramp from South Street.
- See page 5 for nighttime closures of eastbound and westbound I-4 ramps to S.R. 408.
- See page 7 for nighttime closures of westbound S.R. 408 and the westbound S.R. 408.

### Traveling eastbound S.R. 408 to eastbound I-4:

- Use Exit 9 to Orange Blossom Trail
- Turn left onto Orange Blossom Trail
- Turn right onto Colonial Drive (S.R. 50)
- Follow signs to westbound I-4

### Traveling eastbound S.R. 408 to westbound I-4:

- Use Exit 9 to Orange Blossom Trail
- Turn right onto Orange Blossom Trail
- Follow signs to westbound I-4





# BUILDING A BETTER I-4

## Stay Informed:

- » Project Hotline: 844-ULT-INFO (858-4636)
- » Sign up for email and text alerts at [fdot.tips/I4Alerts](https://fdot.tips/I4Alerts)
- » Follow @i4Ultimate on Twitter
- » Subscribe to our monthly newsletter at [fdot.tips/I4News](https://fdot.tips/I4News)

## WESTBOUND S.R. 408 CLOSURES

The Florida Department of Transportation (FDOT) is closing westbound State Road (S.R.) 408 over I-4 from 9 p.m. Thursday, May 14, to 5 a.m. Friday, May 15. The westbound S.R. 408 ramp to westbound Interstate 4 (I-4) and the westbound S.R. 408 entrance ramp from Division Avenue will also be closed.

Multiple closures will be implemented at various times between May 11-18.

- See page 1 for westbound I-4 lane closures through downtown Orlando.
- See page 2 for the nighttime detour of westbound I-4 downtown.
- See page 3 for the 7-day closure of westbound exit to Anderson Street.
- See page 4 for nighttime detours of westbound on ramp from South Street.
- See page 5 for nighttime closures of eastbound and westbound I-4 ramps to S.R. 408.
- See page 6 for the closure of the eastbound S.R. 408 ramp to eastbound and westbound I-4.

### Traveling to westbound S.R. 408 from Division Avenue:

- Continue south on Division Avenue
- Turn left onto Gore Street
- Turn left onto Orange Avenue
- Turn left onto South Street
- Turn right on Garland Avenue
- Turn left on Central Boulevard
- Turn left on Hughey Avenue
- Turn right on South Street
- Turn left onto Orange Blossom Trail (U.S. 441/17-92)
- Follow signs to westbound S.R. 408



### Traveling westbound on S.R. 408:

- Use Exit 11A to Rosalind Avenue
- Turn right on Rosalind Avenue/Magnolia Avenue
- Turn left on Colonial Drive (S.R. 50)
- Turn left onto Orange Blossom Trail
- Follow signage to westbound S.R. 408

### Traveling on westbound S.R. 408 to westbound I-4:

- Use Exit 11A to Rosalind Avenue
- Turn left onto South Street
- Turn left onto Orange Avenue
- Turn right onto Kaley Avenue
- Follow signs to westbound I-4